

This Getting Started Guide and the full length EQUINOX® User Manual are available to download online.



# EQUINOX

## 700 | 900

Get these languages and more:

**DE** Deutsch

**FR** français

**KR** 한국어

**RU** русский

**ES** Español

**JP** 日本語

**PT** Português

**ZH** 中文

## GETTING STARTED GUIDE



## QUICK START

1

TURN  
ON

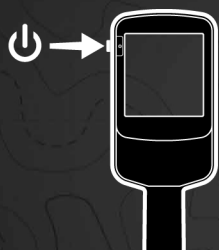

2

SELECT  
SEARCH MODE



3

NOISE  
CANCEL



4

GO  
DETECTING



## SEARCH MODES

\* EQUINOX 900 Only

### PARK

Great for high-trash recreational areas, including most general detecting.



General and  
Coins

Fine  
Jewellery

### FIELD

Ideal for detecting in historical fields for the widest range of target sizes.



Coins and  
Artefacts

Fine Coins and  
Artefacts

### BEACH

For all salty conditions — dry sand, wet sand, surf and underwater.



Wet and  
Dry Sand

Underwater  
and Surf

### GOLD\*

For gold nugget prospecting in mineralised gold field locations.



Normal  
Ground

Difficult  
Ground

## ASSEMBLY

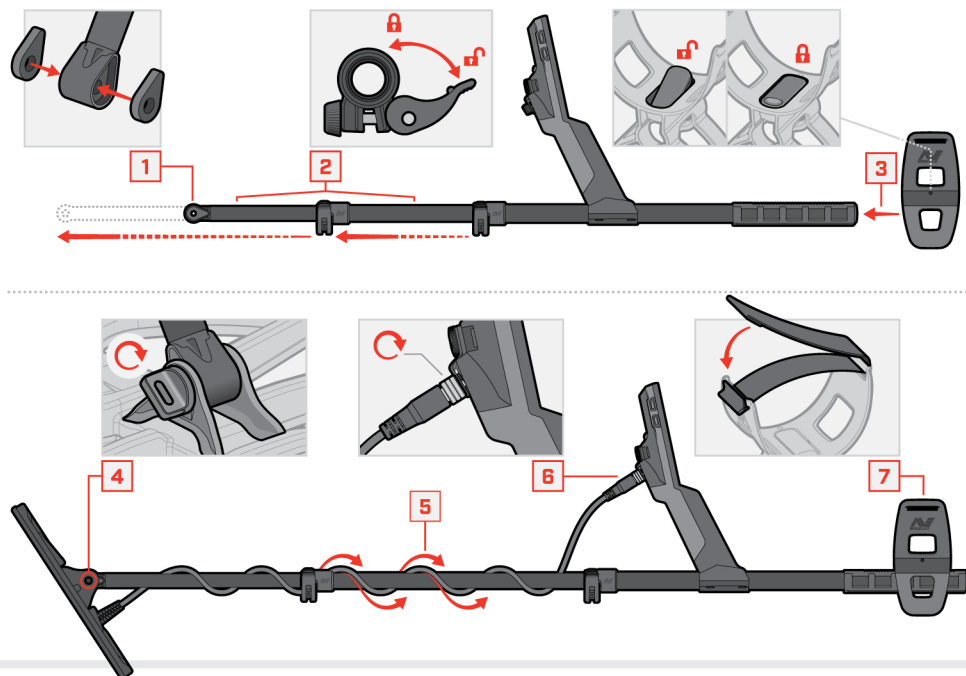

## TIGHTEN CAMLOCKS

Tighten the Camlocks if they slip or become loose.



Open



Tighten gently in increments



Close

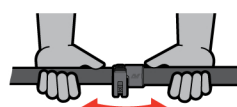

Check and repeat if needed

## CHARGING

5-6 HOURS

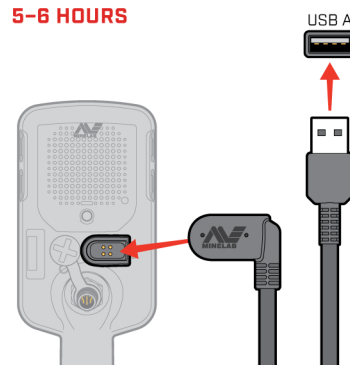

**!** Charge your detector with a good-quality USB charger that has a minimum charging capacity of 2 A @ 5V.

Risk of USB charger failure if a low quality charger is used.

Look for the following marks on USB chargers:



3 HOURS



## CONTROLS & DISPLAY



\* EQUINOX 900 Only