

CTX 3030

The Future of Discovery

Getting Started Guide

Guide de démarrage

Handbuch Erste Schritte

Guida introduttiva

Pierwsze kroki



Guia de Introdução

Руководство по началу работы

Guía de introducción

Başlangıç Kılavuzu



FBS 2 Smartfind 2  

World's Best Metal Detection Technologies

MINELAB
www.minelab.com

Congratulations on purchasing your Minelab

CTX 3030

metal detector!

Congratulations on purchasing your new Minelab CTX 3030.

Metal detecting is a fascinating and rewarding activity enjoyed by many people around the world. With your CTX 3030 you will become one of the many successful detectorists who combine their passion for the outdoors with the excitement of discovering valuable coins, relics, gold and jewelry on a regular basis.

The CTX 3030 is Minelab's most advanced high performance TREASURE detector and will find you more treasure amongst trash than any other detector. It incorporates integrated GPS functions, wireless audio options and the most advanced target discrimination available in a sleek, sturdy, waterproof design.

With the CTX 3030 and the XChange 2 PC application you can download, upload, edit and store detector settings and GPS data, such as FindPoints (find locations) and GeoHunts (entire hunts), using your Personal Computer (PC).

The CTX 3030 will locate valuable metal objects in a variety of mineralized ground conditions, including extremely salty soils, sea water, wet beach sand and highly magnetic ground conditions. Versatile features allow you to easily customize your CTX 3030 for your specific requirements.

This Getting Started Guide explains detector assembly, battery charging and the basic functions necessary to go detecting with a minimum of fuss. To achieve the best results from your CTX 3030 we recommend you read this guide and also the comprehensive Instruction Manual on the CD supplied.

Minelab wishes you every success with your CTX 3030 and experiencing The Future of Discovery.

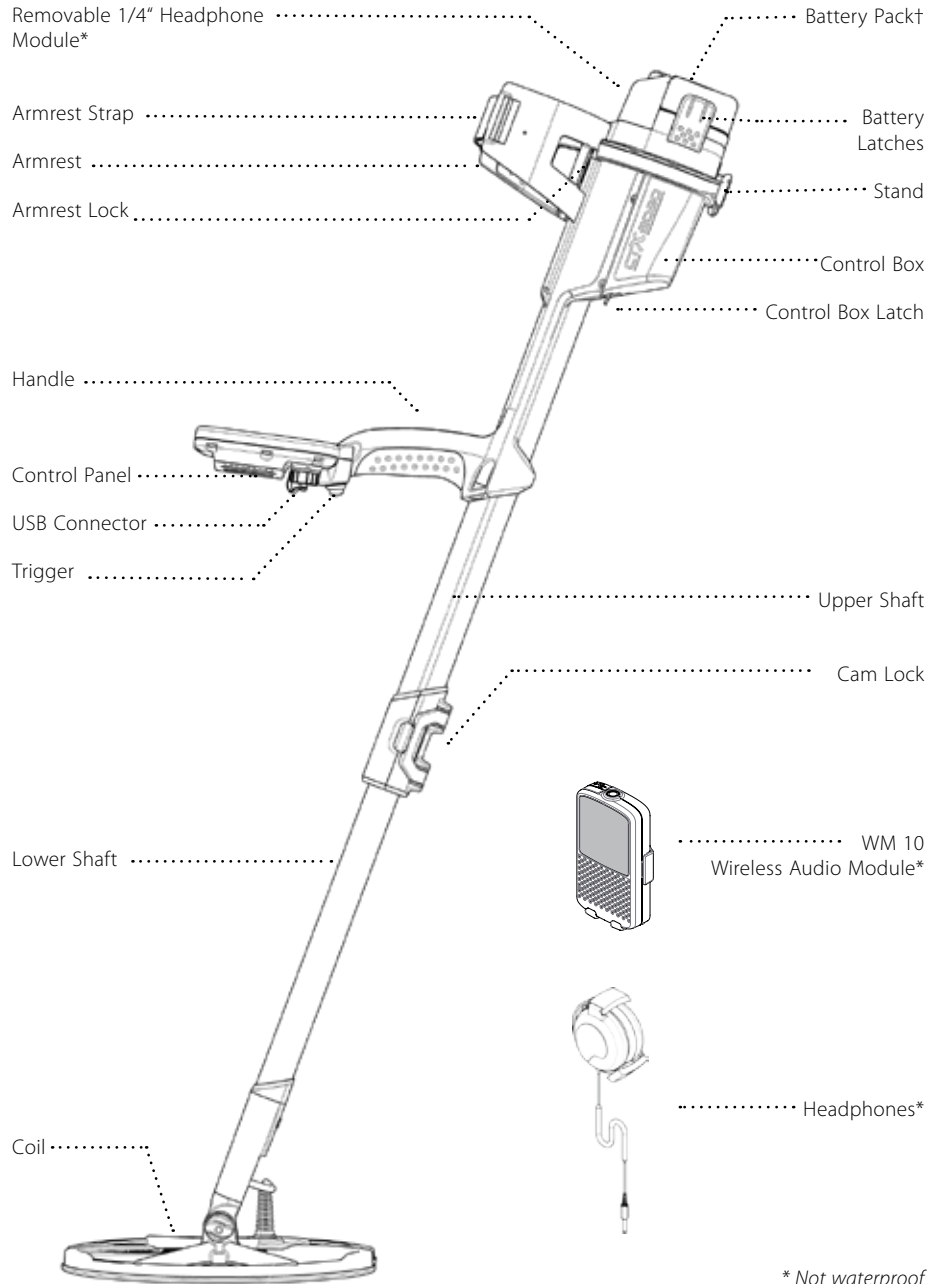

* Not waterproof
 † Waterproof only when attached

Attach Coil to Lower Shaft

1. Plug the two rubber washers into the holes on either side of the lower shaft.
2. Feed the coil cable up through the inside of the lower shaft.

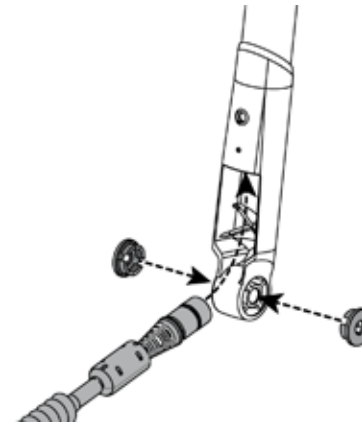

3. Place the coil on a flat surface and slide the lower shaft into the bracket on top of the coil. Ensure that the open side of the lower shaft faces the rear of the coil.

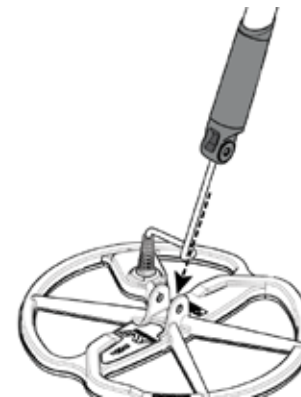

4. Insert the bolt through the lower shaft and the bracket. Fasten with the nut provided.

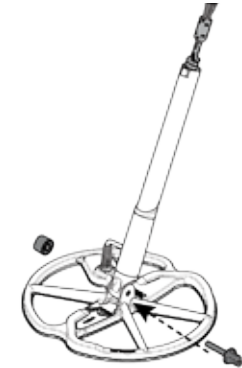

Attach Lower Shaft to Upper Shaft

1. Release the cam lock on the upper shaft by pulling the lever away from the shaft.

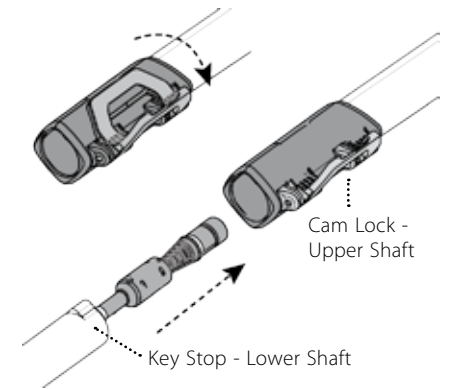

2. The lower shaft can only be inserted into the upper shaft in one orientation. Ensure that the key stop on the lower shaft is aligned to the upper shaft.
3. Slide the lower shaft into the upper shaft until the coil cable and key stop appear at the top.

4. Rotate the upper shaft 90° so that the control panel points upwards.

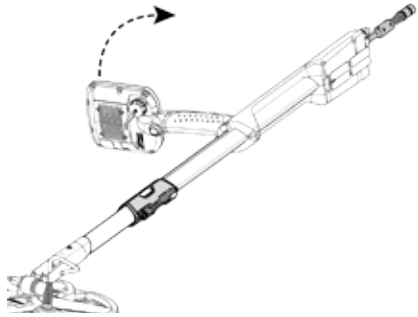

5. Lock the cam lock by pushing the lever towards the shaft



WARNING

PINCH POINTS - CONTROL BOX. Take care when sliding the control box onto the chassis and when operating the control box latch.

Attach Control Box

1. Slide the control box partly onto the upper shaft. When it reaches half way it will click into place to hold the control box while the connectors are fitted. Attach the coil and control panel cables to their respective connectors, and firmly tighten the retaining rings.

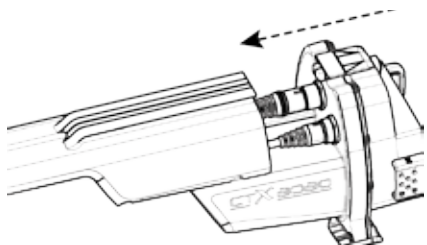

2. Slide the control box further along the upper shaft until it locks into place.
3. Fit the battery pack onto the control box and close the latches to secure it in place.
4. Fit the headphone module onto the control box. Use a screwdriver or coin to gently tighten the bolt taking care not to damage the thread by over-tightening.



NOTE

The headphone module is NOT waterproof. Refer to the CTX 3030 Instruction Manual for further information on using the waterproof headphones.

Attach Armrest

1. Turn the armrest lock counter-clockwise until it is fully open.
2. Slide the armrest onto the rail on top of the chassis. Ensure that the sloping sides of the armrest face toward the control panel.

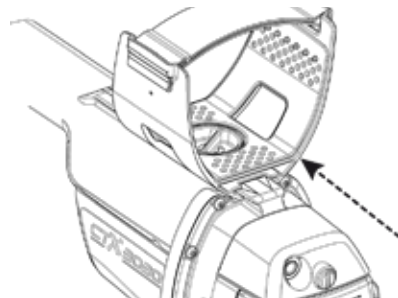

3. Hold the detector as if detecting and slide the armrest along the rail until it is positioned just below your elbow.
4. Remove your arm from the armrest and turn the armrest lock clockwise to lock it into position.

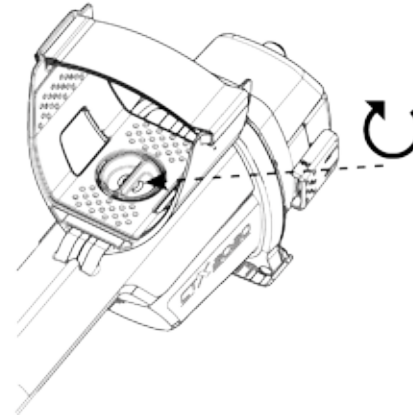

Adjust Armrest Strap

1. Loosen the armrest strap by lifting the top edge.
2. Tighten the strap until your arm is secure in the armrest, and fasten.

NOTE

To fit a smaller arm, the strap can be fitted upside down and passed through the armrest three times.

Recharge Li-Ion Battery Pack with BC 10 Battery Charger

1. Place the Li-Ion Battery Pack into the charger unit, ensuring that the pins line up.

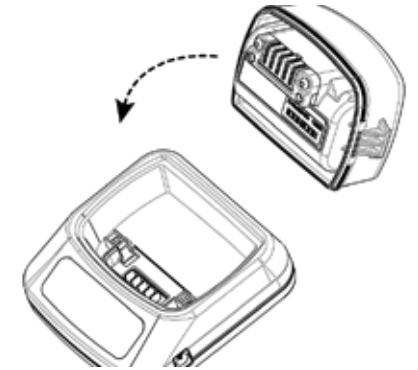

2. Insert the plug pack (or car charger) connector into the socket on the charger unit.

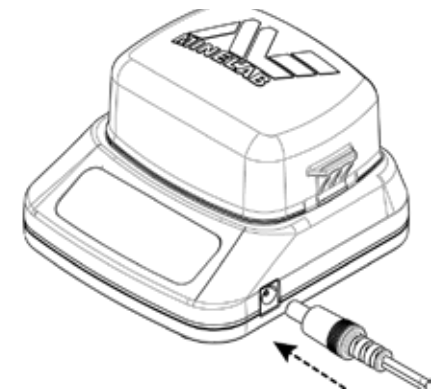

3. Plug the other end of the cable into the wall (or car socket) and turn on the switch. Leave the unit to recharge.

The green indicator light will stop flashing when the battery is fully charged (up to 4 hours).

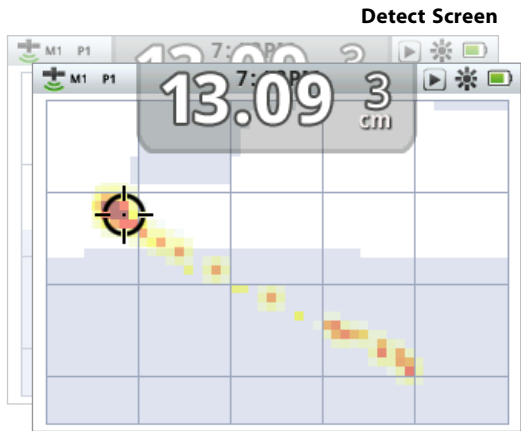

Detect Screen

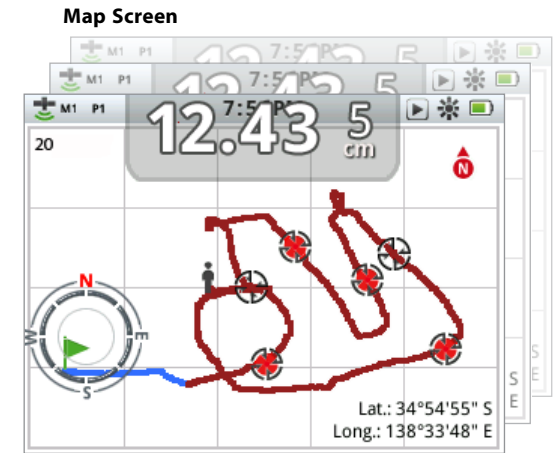

Map Screen

Trigger
 Press to activate the Pinpoint function.
 Press from menu screens to cancel the current action and move back one level.



Power Button
 Press to turn the CTX 3030 On/Off
 Press and hold to reset the detector

User Button
 Press to activate your selected function
 Press and hold to access the User menu

Detect
 Press to view the Detect screen and toggle between Discrimination Patterns
 Press and hold to control Detect options

Map
 Press to view the map screen and cycle between zoom levels
 Press and hold to control Map options

Identify
 Press to accept or reject a target area
 Press and hold to change the Edit Frame size



Detect Screen Control Buttons

Map Screen Control Buttons



Store
 Press to record a WayPoint or FindPoint
 Press and hold to access the GeoHunt menu

Function Buttons



Noise Cancel/Up Arrow
 Press and hold to access the Noise Cancel Quick Menu
 Press to adjust Noise Cancel
 Press from the menus to move upwards



Sensitivity/Left Arrow
 Press and hold to access the Sensitivity Quick Menu
 Press to adjust Sensitivity
 Press from the menus to move left



Menu/Select
 Press and hold to access the Main Menu screen
 Press from the menus to select a menu option

Audio/Right Arrow
 Press and hold to access the Audio Quick Menu
 Press to adjust Audio
 Press from the menus to move right



Ground Balance/Down Arrow
 Press and hold to access the Ground Balance Quick Menu
 Press to adjust Ground Balance
 Press from the menus to move downwards



Adjust the Length of the Shafts

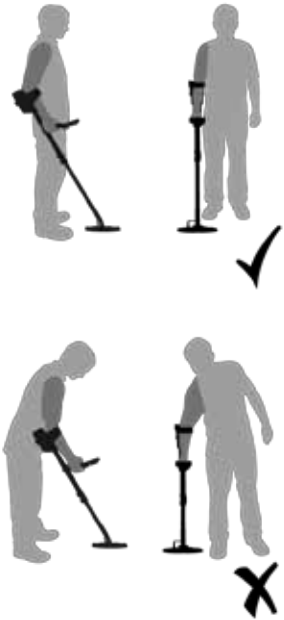

Adjust the Angle of the Coil

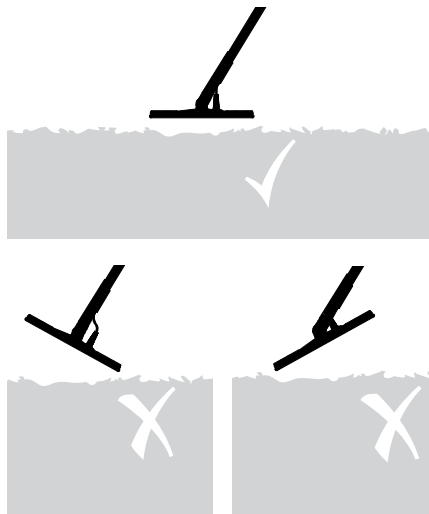

Turn On and Go

 Press the Power button to turn the detector on.

The detector will begin with a startup screen and tune, after which the Detect screen will appear.

 If the detector is erratic due to electrical interference, press Noise Cancel and wait approximately 25 seconds.

The CTX 3030 is ready to find treasure.

Sweeping the Coil

Sweep the coil over the ground in a side-to-side motion while slowly walking forward at the end of each sweep. Slightly overlap the previous sweep to ensure full ground coverage.

An average sweep speed is four seconds from left to right to left.

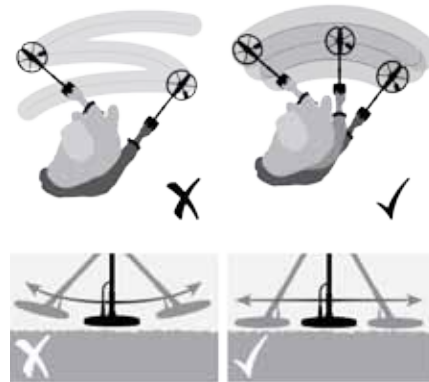

For full details on using your CTX 3030, refer to the Instruction Manual on the CD supplied.

COMPLIANCE

**Information to the User (FCC Part 15.105)
NOTE: Class B Devices**

This equipment has been tested and found to comply with the limits for a Class B digital device, pursuant to part 15 of the FCC Rules. These limits are designed to provide reasonable protection against harmful interference in a residential installation.

This equipment generates, uses and can radiate radio frequency energy and, if not installed and used in accordance with the instructions, may cause harmful interference to radio communications. However, there is no guarantee that interference will not occur in a particular installation. If this equipment does cause harmful interference to radio or television reception, which can be determined by turning the equipment of and on, the user is encouraged to try to correct the interference by one or more of the following measures:

- Reorient or relocate the receiving antenna
- Increase the separation between the equipment and receiver
- Connect the equipment into an outlet on a circuit different from that to which the receiver is connected
- Consult the dealer or an experienced radio/TV technician for help

DISCLAIMER

The Minelab metal detector discussed in this instruction manual has been expressly designed and manufactured as a quality hobbyist metal detector and is recommended for use in coin, treasure and general metal detection in nonhazardous environments. This metal detector has not been designed for use as a mine detector or as a live munitions detection tool.

PLEASE NOTE

Since there may be a variety of options available for this detector, equipment may vary according to the Model or items ordered with your detector. Certain descriptions and illustrations may also differ (in this manual) from the exact Model that you purchased. In addition, Minelab reserves the right to respond to ongoing technical progress by introducing changes in design, equipment and technical features at any time.

SOFTWARE

Certain components of the XChange2 PC software application for use in conjunction with the Minelab CTX 3030 are subject to the GNU General Public License, Version 2 ('GPLv2'; www.gnu.org/copyleft/gpl.html), or other open source licenses ('Open Source Software'). In compliance with the terms of these Open Source Software licenses, the Open Source Software that Minelab uses, modifies and distributes is made available to the public, in source code form, at www.minelab.com/open-source. Complete details of the applicable licenses can be downloaded from this website, and can also be found on the installation CD for the software that is included in the box with the CTX 3030 detector.



Minelab Electronics Pty Ltd

Tel: +61 (0) 8 8238 0888

Email: minelab@minelab.com.au



Minelab International Ltd

Tel: +353 (0)21 423 2352

Email: minelab@minelab.ie



Minelab Americas Inc

Tel: +1 630 401 8150

Email: info@minelabamericas.com

